



AIR6-1450

高速度
高精度
高稳定性
紧凑的中空臂

High speed
High precision
High stability
Compact hollow arm

- 更适于狭窄空间内作业。
More suitable for narrow space operation.
- 针对民用及工业领域中的焊接应用而研发, 主要用于五金工具、金属家具、汽车维修、建筑、船舶、管道工程、通用机械等行业, 也可用于搬运、码垛、上下料等作业。
AIR6-1450 is developed for welding applications in civil and industrial fields, mainly used in the fields of hardware tools, metal furniture, automobile maintenance, construction, shipbuilding, pipe engineering, general machinery, also can be used in handling, palletizing, loading & unloading.

型号 Type		AIR6-1450
轴数 Axes		6
负载 Payload		6kg
机器人本体 Manipulator	重量 Weight	170kg
	最大运动范围 Reach	1455mm
定位精度 Positioning accuracy	位置重复定位精度 Position repeatability	±0.06mm
IP 等级 Ingress Protection		IP54 (腕部 : IP67) IP54 (Wrist : IP67)
安装方式 Mounting		地装 Floor
运动范围 Working range	轴 1* Axis 1 rotation	-170°/+170°
	轴 2 Axis 2 arm	-85°/+150°
	轴 3 Axis 3 arm	-95°/+160°
	轴 4 Axis 4 wrist	-155°/+155°
	轴 5 Axis 5 bend	-120°/+120°
	轴 6 Axis 6 turn	-360°/+360°
运动速度 Rotation rate	轴 1 Axis 1 rotation	200°/s
	轴 2 Axis 2 arm	200°/s
	轴 3 Axis 3 arm	230°/s
	轴 4 Axis 4 wrist	430°/s
	轴 5 Axis 5 bend	430°/s
	轴 6 Axis 6 turn	630°/s
适用控制柜 Controllers		inCube20
安装条件 Mounting conditions	环境温度: 0~45℃ Ambient temperature: 0~45℃ 湿度: 恒温下 95% 以内, 无凝露。 Humidity: not more than 95% at constant temperature without condensation. 允许高度: 操作机正常工作环境的海拔高度不应超过 1000 米 (在 1000 米 -4000 米高度范围内, 操作机应降额使用)。 Allowable altitude: not more than 1000m above sea level. 不应有腐蚀性、可燃性、易爆性气体。 No corrosive, flammable or explosive gases.	



* 若去除机械限位, 运动范围可达 -180°/+180°。
If the mechanical limit is removed, the working range can reach -180°/+180°.

外形尺寸及运动范围 Outline dimension and Working range

小中负载 Small/Medium payload

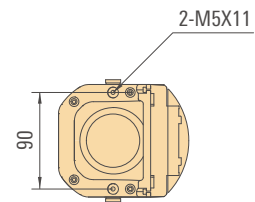
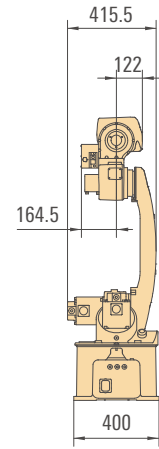
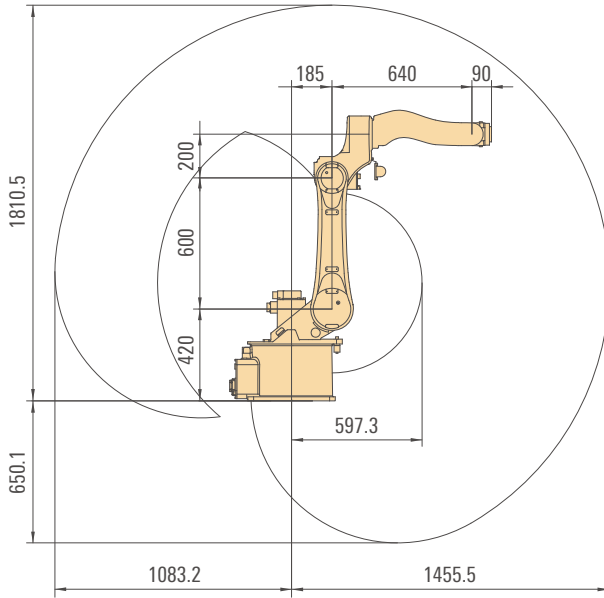

腕部孔位图
Wrist arm

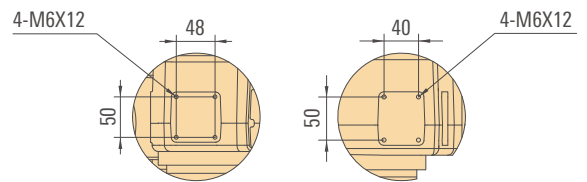
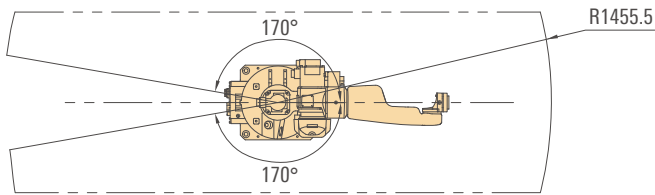

肘部孔位图
Elbow arm

法兰图 Flange drawing

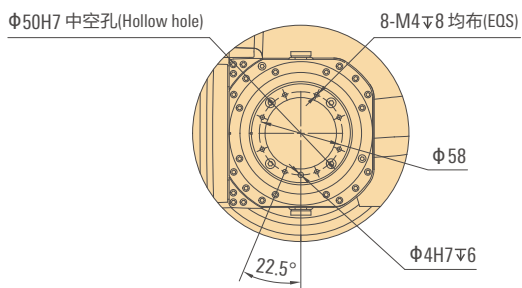

底座安装图 Base installation drawing

