



## AIR15-950

超高速  
高精度  
高稳定性  
高防护等级

High speed  
High precision  
High stability  
IP67

型号 Type		AIR15-950
轴数 Axes		6 (3/4 <sup>2</sup> )
负载 Payload		15kg
机器人本体 Manipulator	重量 Weight	83.5kg
	最大运动范围 Reach	947mm
定位精度 Positioning accuracy	位置重复定位精度 Position repeatability	±0.03mm
IP 等级 Ingress Protection		IP67/ISO5 <sup>③</sup>
安装方式 Mounting		地装 / 壁装 / 吊装 Floor/ wall/ ceiling
运动范围 Working range	轴 1 <sup>①</sup> Axis 1 rotation	-170°/+170°
	轴 2 Axis 2 arm	-100°/+135°
	轴 3 Axis 3 arm	-120°/+156°
	轴 4 Axis 4 wrist	-200°/+200°
	轴 5 Axis 5 bend	-135°/+135°
	轴 6 Axis 6 turn	-360°/+360°
运动速度 Rotation rate	轴 1 Axis 1 rotation	310°/s
	轴 2 Axis 2 arm	320°/s
	轴 3 Axis 3 arm	350°/s
	轴 4 Axis 4 wrist	490°/s
	轴 5 Axis 5 bend	565°/s
	轴 6 Axis 6 turn	815°/s
适用控制柜 Controllers		inCube20
安装条件 Mounting conditions	环境温度: 0~45℃ Ambient temperature: 0~45℃ 湿度: 恒温下 95% 以内, 无凝露。 Humidity: not more than 95% at constant temperature without condensation. 允许高度: 操作机正常工作环境的海拔高度不应超过 1000 米 (在 1000 米-4000 米高度范围内, 操作机应降额使用)。 Allowable altitude: not more than 1000m above sea level. 不应有腐蚀性、可燃性、易爆性气体。 No corrosive, flammable or explosive gases.	

<sup>①</sup> 若去除机械限位, 运动范围可达 -180°/+180°。

If the mechanical limit is removed, the working range can reach -180°/+180°.

<sup>②</sup> AIR15-950 的 3 轴版本指保留原 6 轴版本机体的 J2、J3 和 J5; 4 轴版本可在 3 轴版本上选择增加 J1、J4 或 J6。本体重量会减轻, 其他性能参数不变。

The 3-axis version of AIR12-940 refers to retaining the original 6-axis version body J2, J3 and J5; 4-axis version You can optionally add J1, J4, or J6 to the 3-axis version. Body weight will be reduced, other performance parameters remain unchanged.

<sup>③</sup> 如需 ISO5 版本, 请联系销售。

For ISO 5 version, please contact sales.

- 标准门型节拍时间 0.44S。  
Standard cycle time 0.44s.
- 二、三、五轴运动范围更大。  
Larger range of motion for Axis 2, 3, 5.
- 内置气路可容纳气量翻倍。  
The built-in gas hoses double the air volume.
- 隐藏及分离式设计, 避免航插对外挂设备的干扰。  
Hidden and separated design avoids interference with external devices brought by the arm connector.
- 线缆固定孔位加深, 数量加倍, 保证高速运转下线束贴合本体更牢固。  
The number and depth of the mounting holes are increased, ensuring that wiring harness keeps adhering to the body firmly at high speed.
- 除六轴版本外, 还为 PCB 行业提供三、四轴高性价比版本。  
Besides the six-axis version, it also provides three and four-axis cost-effective versions for the PCB industry.

### 机体内配线 • 配管 Integrated dressing

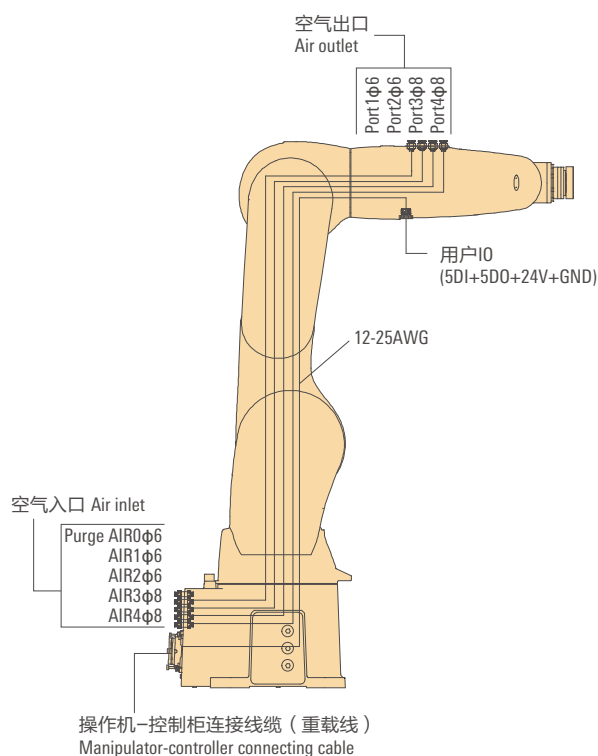

外形尺寸及运动范围 Outline dimension and Working range

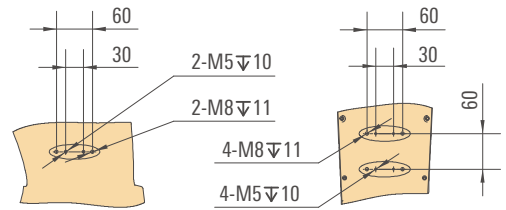
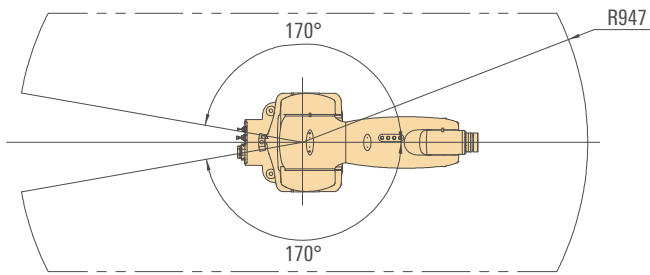
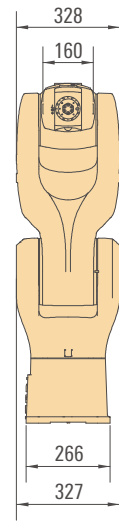
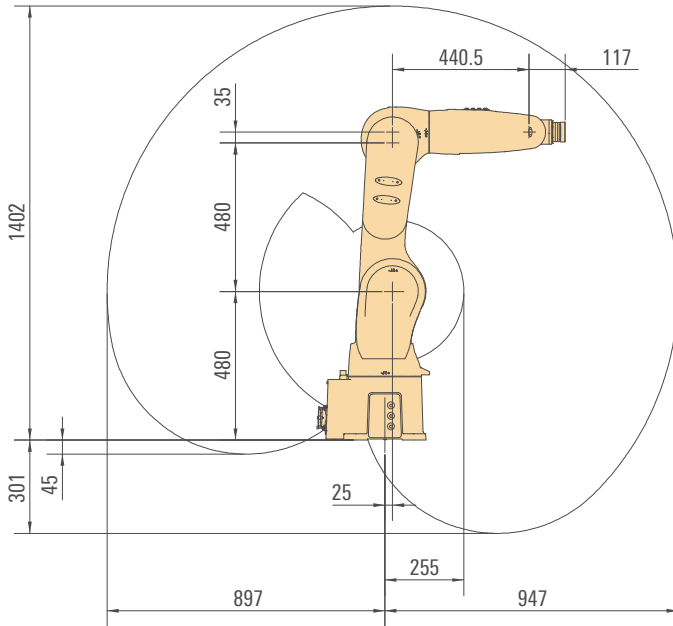

肩部孔位图  
Shoulder arm

大臂孔位图  
Lower arm

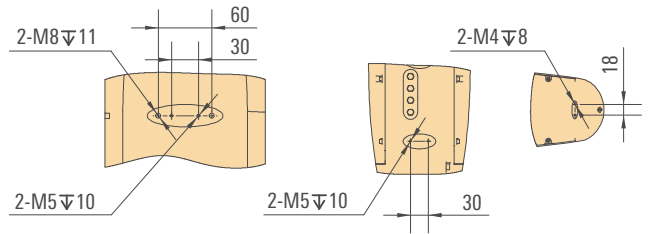

肘部孔位图  
Elbow arm

小臂孔位图  
Upper arm

法兰图 Flange drawing

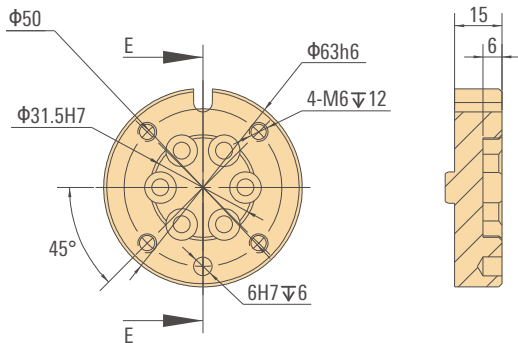

底座安装图 Base installation drawing

